

# HAND SANITIZER DISPENSER

## MANUAL

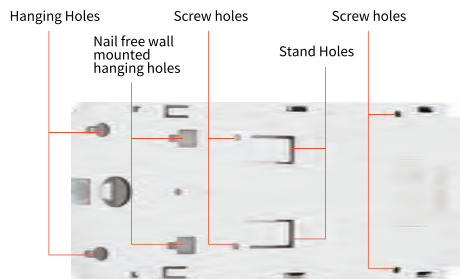

### 1. PRODUCT DESCRIPTION

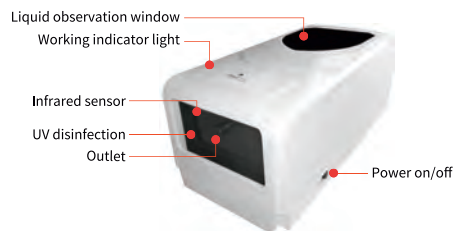

### 2. PRODUCT INSTALLATION

#### Floor stand installation

- (1). Base, Telescopic rod: The thick end of the rod is inserted into the reserved hole of the base.
- (2). Fix the telescopic rod firmly with head screws and washers.
- (3). Pull out the plastic locking ring at the loose circle and pull out the lifting and shrinking rod into the reserved hole of the chassis. Adjust to a suitable height, and then tighten the plastic locking ring.



- (4). On the telescopic pole, use hexagon bolts to fix the baffle.
- (5). Take out the product and hang it on the fixed plate according to the hook in the circle.

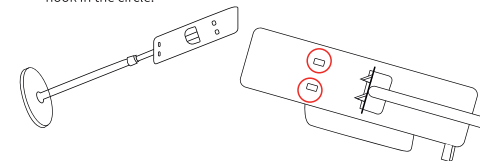

- (6). Wetted box, snap into the fixing plate hole.

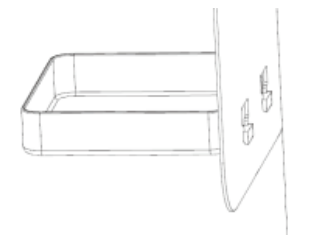

#### Nail free wall mounted

- (1). Tear off the adhesive film and stick it in a suitable position.
- (2). The position inside the circle is fixed on the adhesive sheet. Note that it needs to be fully fitted.



- (3). Pull out the plastic locking ring at the loose circle and pull out the lifting and shrinking rod into the reserved hole of the chassis. Adjust to a suitable height, and then tighten the plastic locking ring.

#### Screw wall mounted

- (1). Drill holes at a suitable position according to the center distance of 80mm.
- (2). Tuck into the wall expansion plastic sleeve.
- (3). As shown in the figure, use screws to fix the body firmly.

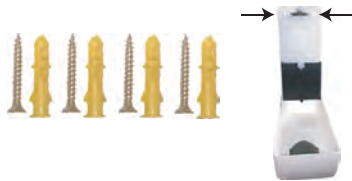

#### Fulfill the supplement

- (1). Use one hand to press firmly on the circle, and the other hand to assist in opening the front cover.
- (2). Unplug the reservoir cartridge and fill with refill liquid.
- (3). Reinstall the reservoir plug and close the front cover.



#### How to replace the battery.

- (1). Open the front cover in the same way as it is filled with replenishing liquid.
- (2). Open the battery cover and replace the battery.

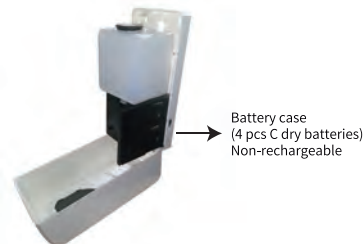

### 3. Specifications

Size	L x W x H (121 x 107 x 261) mm
Capacity	1000 ml (33 oz)
Each Dispenser Capacity	3 ml (0.1 oz)
Liquid Outlet Model	Drip style (apply liquid, gel or soap solution sanitizer)
Operation	Automatic touchless IR sensor
UV Sterilization	Yes
Materials	ABS+PP+PVC
Net Weight	872g / 30.75oz
Battery	4pcs C dry batteries
Working Voltage	3.7V
Working Current	480 mAh
Standby Current	200uA
Waterproof	IPX4
Installation Methods	Wall-mounted style or Floor stand (with floor stand station kits)
Application	Perfect for home, hotels, hospitals, schools, offices and other public places.

### 4. NOTES

Do not keep your hand under the sensor area for a long time, or take anything to cover the sensor area.

This dispenser is drip style only suitable for liquid, gel or soap solution sanitizer. After 3 months used, we would like to suggest you to put some fresh water in to container and clean the tube by putting your hand under the sensor area.

Made in China

